

8902



SOCIALIZING



CLIMBING



SLIDING

## INFORMATION ABOUT THE PRODUCT

Dimensions	177 x 361 cm
Safety zone	507 x 711 cm
Safety zone area	26 m <sup>2</sup>
Overall height	306 cm
Free fall height	195 cm
Amount of users	9
Product complies with EN 1176-1:2017-12	TAK
Availability of spare parts	TAK
Age range	3-12
According to EN 1176-1:2017-12 norm, the product requires applying a safety surface according to the product's free fall height.	



8902

INFORMATION FOR ARCHITECTS

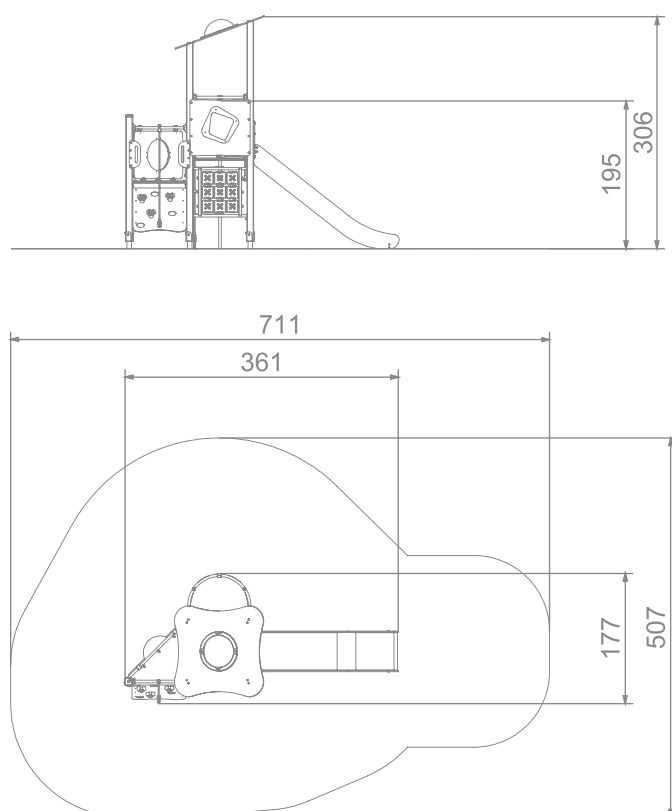

SCALE 1:100

## MATERIALS:

SLIDES MADE OF STAINLESS STEEL AISI 304. METAL SHEET WITH A THICKNESS OF 2 MM FORMED IN A CNC TECHNIQUE.	HEMISPHERIC WINDOW WITH A DIAMETER OF 400 MM.	ANTI-SLIP ANTHRACITE 10MM HPL PLATFORM PLATE WITH A VERY HIGH RESISTANCE TO WEATHER CONDITIONS AND ATTRITION.	THE TIC TAC TOE GAME IS MADE OF POLYETHYLENE ROTATIONALLY MOLDED WITH SYMBOLS ON THE FORM.	PLATES OF THE WALLS MADE OF COLOURFUL TRIPLE LAYERED 15 MM HDPE POLYETHYLENE, IN THE HIGHEST QUALITY, TOTALLY DAMP-PROOF.	CLIMBING ROCKS MADE OF CHIPPINGS AND COLOURFUL POLYESTER RESIN.
SOFT CONIFER WOOD CORELESS, GLUED IN LAYERS WITH POLYURETHANE GLUES, TOTALLY RESISTANT TO WATER.	WOODEN POSTS ANCHORED TO THE GROUND WITH POWDER GALVANIZED AND POWDER COATED STEEL ANCHORS.	CONNECTING ELEMENTS LIKE SCREWS, NUTS, WASHERS MADE OF STAINLESS STEEL.	POLYPROPYLENE ROPES PP-MULTISPLIT TYPE WITH A STEEL CORE AND A DIAMETER OF 16 MM.	SYSTEM OF CONNECTORS AND CLAMPS MADE OF STRONG ALUMINIUM ALLOY.	SOLID AND ESTHETIC ROPE CONNECTORS MADE OF INJECTION MOLDED POLYAMIDE.

