

8068

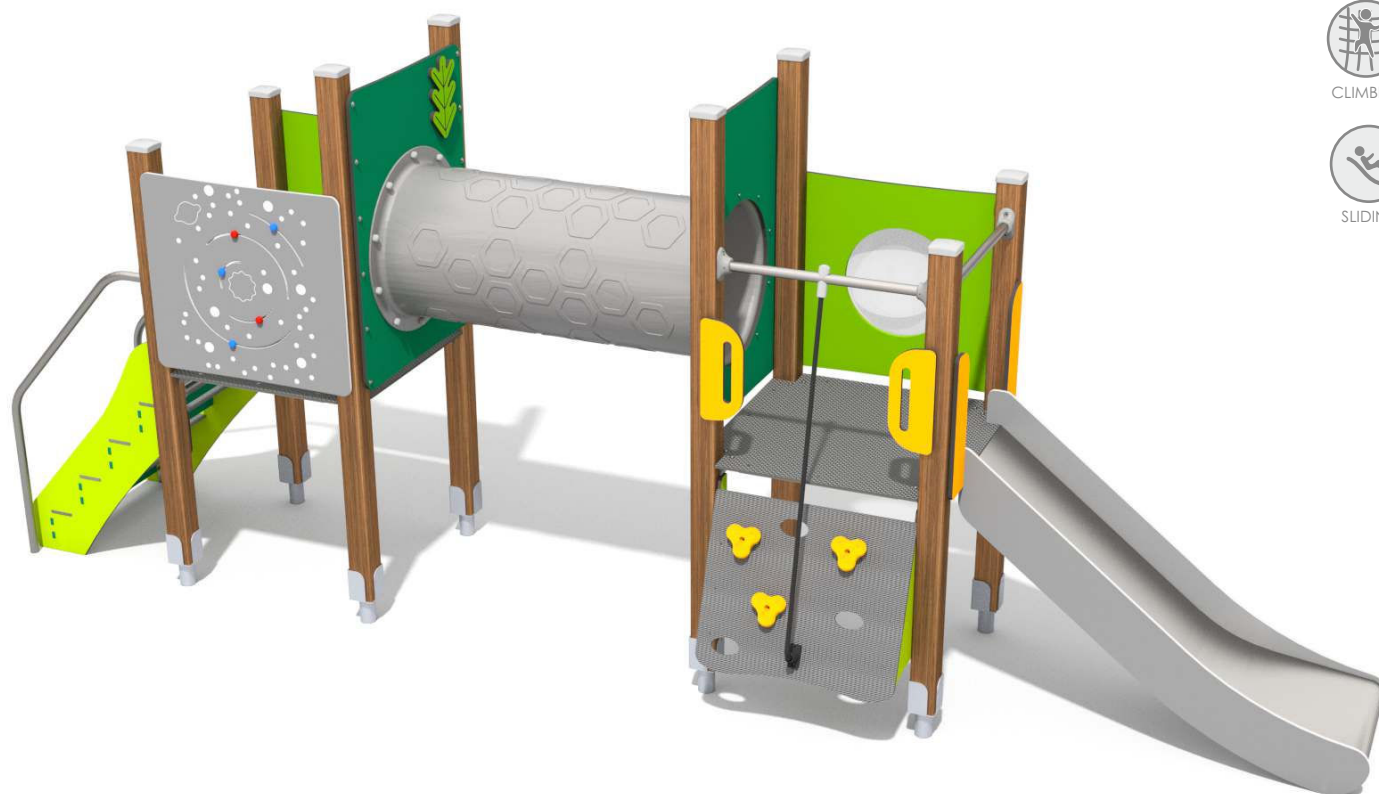

SOCIALIZING



CLIMBING



SLIDING

## INFORMATION ABOUT THE PRODUCT

Dimensions	517 x 131 cm
Safety zone	867 x 431 cm
Safety zone area	31 m <sup>2</sup>
Overall height	212 cm
Free fall height	90 cm
Amount of users	10
Product complies with EN 1176-1:2017-12	YES
Availability of spare parts	YES
Age range	3-12
According to EN 1176-1:2017 norm, the product requires applying a safety surface according to the product's free fall height.	

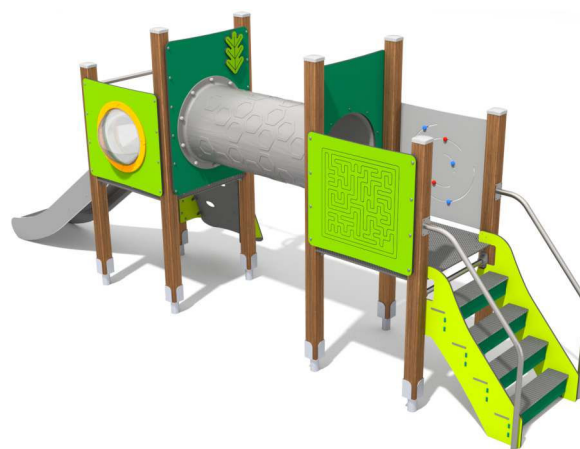

8068

INFORMATION FOR ARCHITECTS

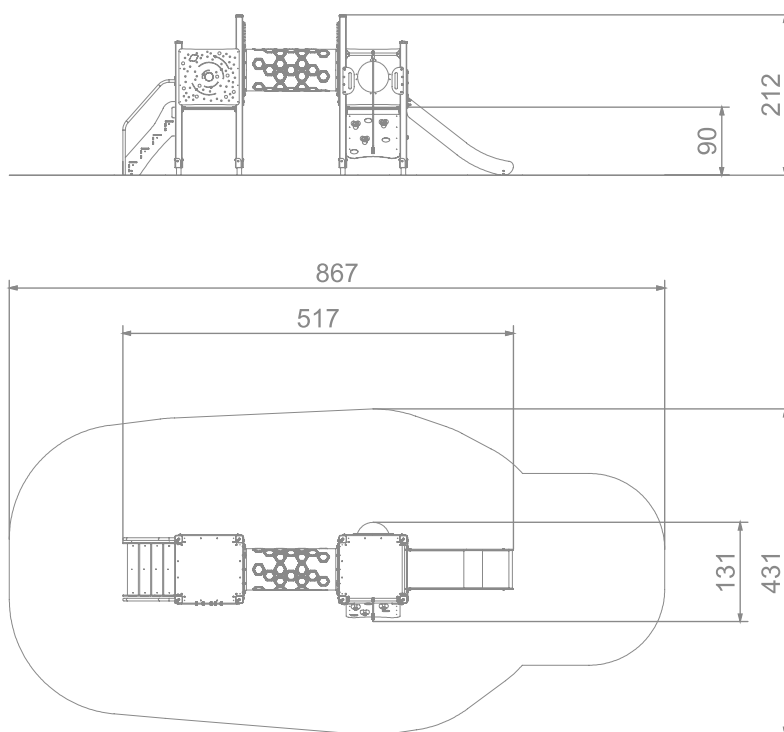

SCALE 1:100

## MATERIALS:

SOFT CONIFER WOOD  
CORELESS, GLUED IN LAYERS  
WITH POLYURETHANE GLUES,  
TOTALLY RESISTANT TO WATER.



WOODEN POSTS  
ANCHORED TO THE  
GROUND WITH POWDER  
GALVANIZED AND  
POWDER COATED STEEL  
ANCHORS.



SLIDES MADE OF STAINLESS  
STEEL AISI 304. METAL SHEET  
WITH A THICKNESS OF 2 MM  
FORMED IN A CNC  
TECHNIQUE.



SYSTEM OF CONNECTORS  
AND CLAMPS MADE OF  
STRONG ALUMINIUM  
ALLOY.



HEMISPHERIC WINDOW  
WITH A DIAMETER  
OF 400 MM.



CLIMBING ROCKS MADE  
OF CHIPPINGS AND  
COLOURFUL POLYESTER  
RESIN.



POLYPROPYLENE ROPES  
PP-MULTISPLIT TYPE  
WITH A STEEL CORE AND  
A DIAMETER OF 16 MM.



TUBE MADE OF LDPE  
POLYETHYLENE  
ROTATIONALLY MOLDED  
WITH THE INNER DIAMETER  
OF 53.3 CM AND THE  
LENGTH OF 125 CM.

