

8058



SOCIALIZING



SENSORIAL  
INTEGRATION



## INFORMATION ABOUT THE PRODUCT

Dimensions	311 x 589 cm
Safety zone	611 x 889 cm
Safety zone area	43 m <sup>2</sup>
Overall height	142 cm
Free fall height	103 cm
Amount of users	10
Product complies with EN 1176-1:2017	YES
Availability of spare parts	YES
Age range	3-12
According to EN 1176-1:2017 norm, the product requires applying a safety surface according to the product's free fall height.	

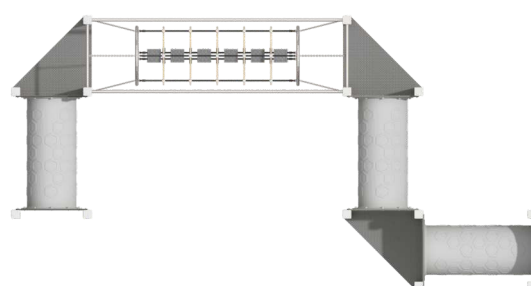

8058

INFORMATION FOR ARCHITECTS

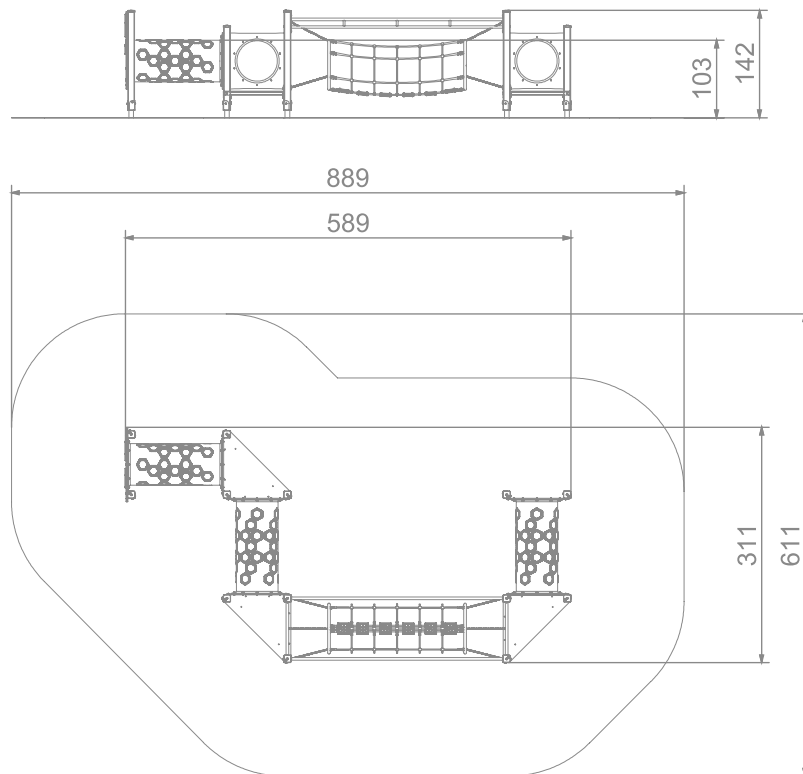

SCALE 1:100

#### MATERIALS:

SOFT CONIFER WOOD  
CORELESS, GLUED IN LAYERS  
WITH POLYURETHANE GLUES,  
TOTALLY RESISTANT TO WATER.



WOODEN POSTS  
ANCHORED TO THE  
GROUND WITH POWDER  
GALVANIZED AND  
POWDER COATED STEEL  
ANCHORS.



PLATES OF THE WALLS  
MADE OF COLOURFUL  
TRIPLE LAYERED 15 MM  
HDPE POLYETHYLENE, IN  
THE HIGHEST QUALITY,  
TOTALLY DAMP-PROOF.



ANTI-SLIP ANTHRACITE  
10MM HPL PLATFORM  
PLATE WITH A VERY HIGH  
RESISTANCE TO WEATHER  
CONDITIONS AND  
ATTRITION.



TUBE MADE OF LDPE  
POLYETHYLENE  
ROTATIONALLY MOLDED  
WITH THE INNER DIAMETER  
OF 53.3 CM AND THE  
LENGTH OF 125 CM.



CONNECTING ELEMENTS  
LIKE SCREWS, NUTS,  
WASHERS MADE OF  
STAINLESS STEEL.



THE PASSAGE MODULE  
MADE OF  
POLYPROPYLENE ROPE  
WITH A DIAMETER OF 16  
MM

