

8038



SOCIALIZING



SLIDING

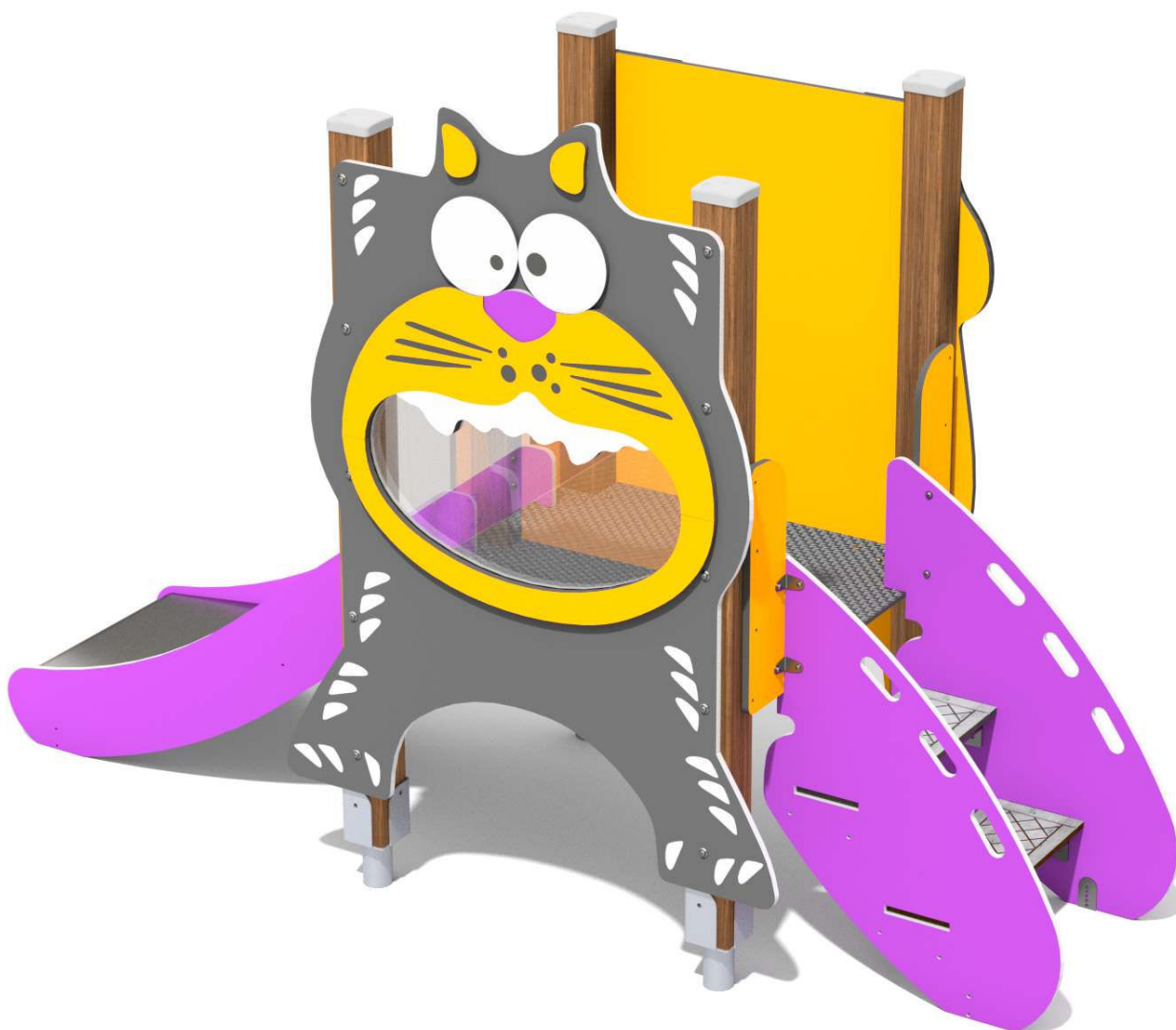

## INFORMATION ABOUT THE PRODUCT

Dimensions	253 x 95 cm
Safety zone	603 x 395 cm
Safety zone area	19 m <sup>2</sup>
Overall height	170 cm
Free fall height	59 cm
Amount of users	4
Product complies with EN 1176-1:2017-12	YES
Availability of spare parts	YES
Age range	1-8
According to EN 1176-1:2017 norm, the product requires applying a safety surface according to the product's free fall height.	



8038

INFORMATION FOR ARCHITECTS

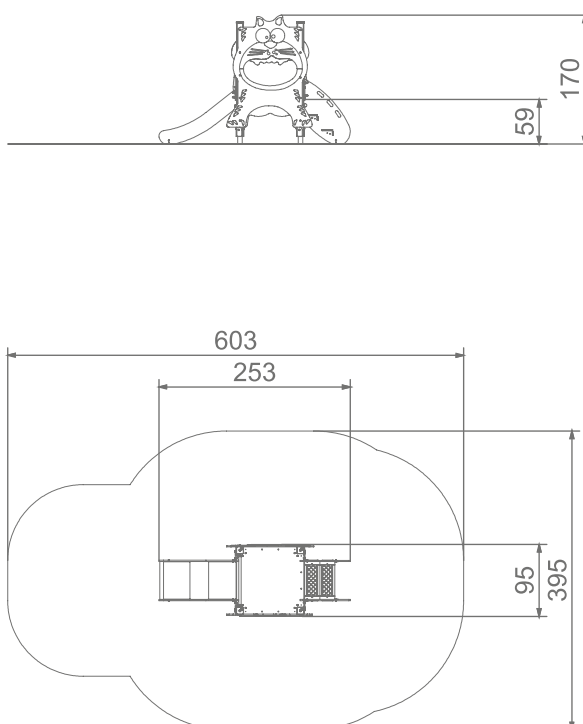

SCALE 1:100

## MATERIALS:

SOFT CONIFER WOOD  
CORELESS, GLUED IN LAYERS  
WITH POLYURETHANE GLUES,  
TOTALLY RESISTANT TO WATER.



WOODEN POSTS  
ANCHORED TO THE  
GROUND WITH POWDER  
GALVANIZED AND  
POWDER COATED STEEL  
ANCHORS.



PATENTED SYSTEM OF  
CONNECTORS AND  
CLAMPS MADE OF  
STRONG ALUMINIUM  
ALLOY.

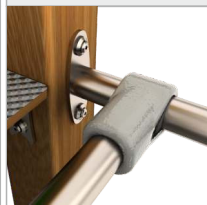

ANTI-SLIP ANTHRACITE  
10MM HPL PLATFORM  
PLATE WITH A VERY HIGH  
RESISTANCE TO WEATHER  
CONDITIONS AND  
ATTRITION.



SLIDES MADE OF STAINLESS  
STEEL AISI 304. METAL SHEET  
WITH A THICKNESS OF 2 MM  
FORMED IN A CNC  
TECHNIQUE.



SYSTEM OF CONNECTORS  
AND CLAMPS MADE OF  
STRONG ALUMINIUM  
ALLOY.



PLATES OF THE WALLS  
MADE OF COLOURFUL  
TRIPLE LAYERED 15 MM  
HDPE POLYETHYLENE, IN  
THE HIGHEST QUALITY,  
TOTALLY DAMP-PROOF.

