

4152

SINGLE



#### INFORMATION ABOUT THE PRODUCT

|  |                   |
|--|-------------------|
| Dimensions   | 13 x 90 cm        |
| Safety zone  | 313 x 390 cm      |
| Safety zone area   | 11 m <sup>2</sup> |
| Overall height   | 125 cm            |
| Free fall height   |                   |
| Amount of users  | 1                 |
| Product complies with EN 1176-1:2017-12  | YES               |
| Availability of spare parts  | YES               |
| Age range  | 1-7               |
| According to EN 1176-1:2017-12 norm, the product requires applying a safety surface according to the product's free fall height. |                   |

4152

**SINGLE**

INFORMATION FOR ARCHITECTS

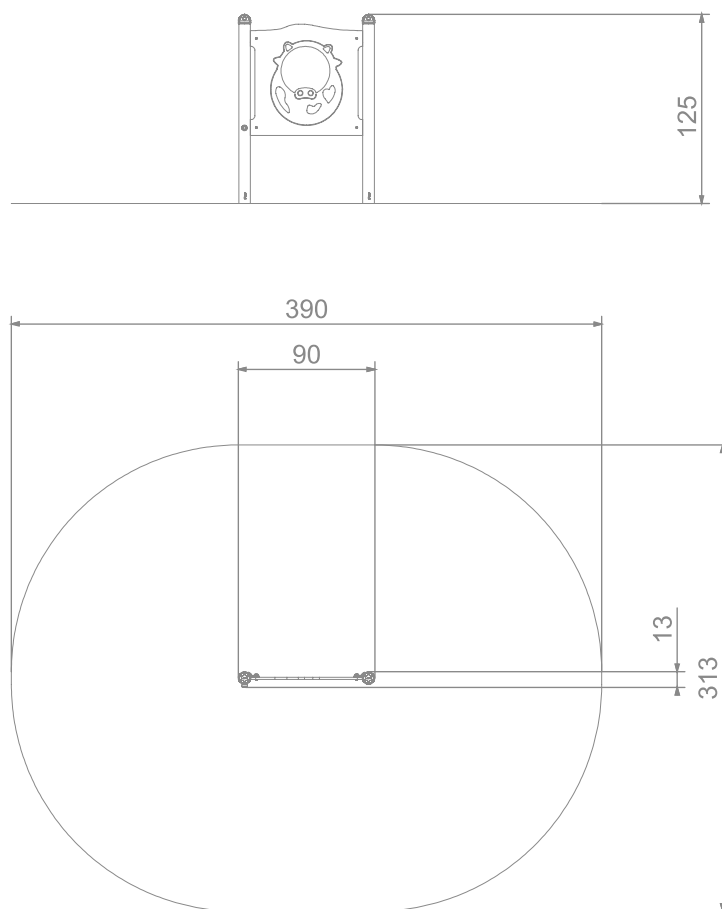

SCALE 1:50

#### MATERIALS:

SOLID CONSTRUCTION  
MADE OF STAINLESS STEEL  
AISI 304 TOTALLY RESISTANT  
TO WEATHER CONDITIONS



PLATES OF THE WALLS MADE  
OF COLORFUL TRIPLE  
LAYERED 15 MM HDPE  
POLYETHYLENE



SAFE PIPE PLUGS MADE OF  
INJECTION MOLDED  
POLYAMIDE



PLATE AND ROPE  
CONNECTORS MADE OF  
INJECTION MOLDED  
POLYAMIDE

